

Construction Update

Week of | 9/21/15

Site Activity | Deep Dynamic Compaction and Installation of Water and Sanitary Lines

This is an update on construction work at Skyland Town Center. Site work is underway to prepare the site for the future construction of buildings. We are currently in the process of Deep Dynamic Compaction.

Deep Dynamic Compaction is a ground development technique used to strengthen soil by dropping a heavy weight repeatedly on the ground at regularly spaced intervals. The purpose of the compaction is to ensure a firm foundation for the center. This process will start at Alabama Avenue and continue toward Naylor Road, the phases are illustrated in the attached site map.

- Deep Dynamic Compaction Phase 1 commenced 9/21/15 and will continue through 10/15/15
- Deep Dynamic Compaction Phase 2 will commence 10/16/15 and will continue through 11/2/15

New water and sanitary lines will be installed within Alabama, Good Hope and Naylor Roads.

- Work is expected to commence 10/2/15 and will continue through January 2016.
- Some of the utility work will be in public space and will affect traffic. Updated phasing and traffic control plans will be posted shortly.

I:\Terraviva\1\AJ\Project Files\2007\07641D Skyland Detaining Wall\StabilCAD\VIBRATION MONITORING\VIBRATION MON. 07641C.dwg Jan 22, 2014 - 2:01pm

LEGEND:

- DENOTES PROPOSED BORING LOCATIONS (53)
- DENOTES TEST PIT LOCATIONS (6)
- DDC REQUIRED - STRUCTURAL AREA
- NON- STRUCTURAL AREA - PARKING LOTS CAN BE TREATED BY EITHER DDC OR SURFACE MODIFICATION
- STRUCTURAL AREA - DDC, SURCHARGE OR OTHER MODIFICATION REQUIRED
- NON-STRUCTURAL AREA - CAN BE TREATED LOCALLY BY DDC, SURCHARGE OR OTHER SURFACE MODIFICATION
- STRUCTURAL AREA - OTHER FOUNDATION / MODIFICATION REQUIRED

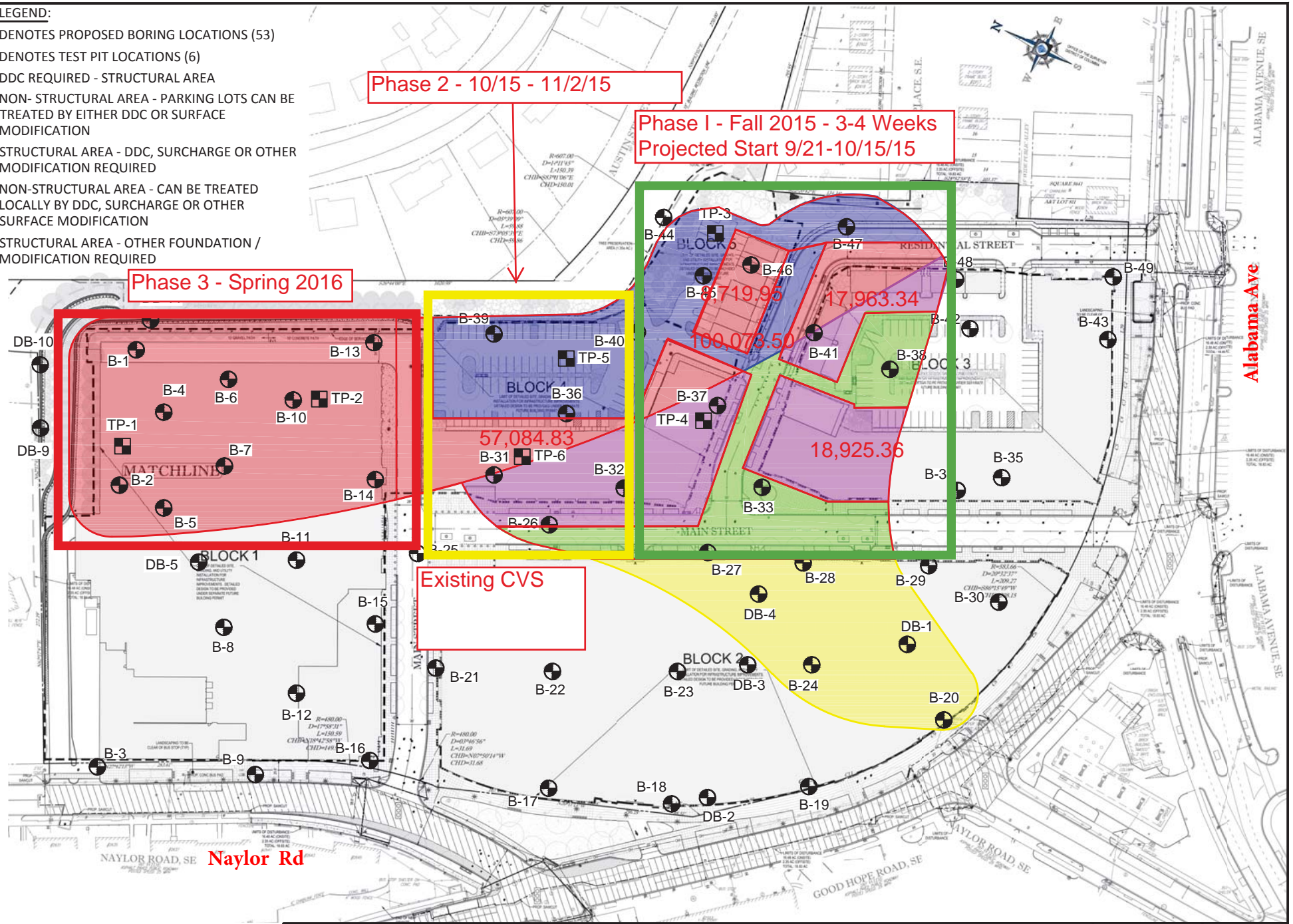

HILLIS-CARNES
ENGINEERING ASSOCIATES
 10975 Guilford Road, Suite A Annapolis Junction, Maryland
 (410) 880-4788 WWW.HCEA.COM Fax: (410) 880-4098

DDC DELINEATION PLAN
SKYLAND SHOPPING CENTER
REDEVELOPMENT PROJECT

PROJECT NO.	07641D	DRAWN BY	AM
DATE	01/22/14	CHECKED BY	MJ
SCALE	1" = 150'		
SHEET	1		